

COMPANY: The Buchan Group
ADDRESS: 342 WICKHAM STREET
FORTITUDE VALLEY, QLD 4006

CONTACT: GREG SHEEHAN
PHONE: +61 7 3859 9222
FAX: +61 7 3859 9234
WEB: www.buchan.com.au

The Buchan Group is one of the most substantial architectural groups in Australasia, with a design philosophy that comes from a thorough understanding of the ambient and aesthetic requirements of the project and its users, and a commitment to designing buildings which are fit for their purpose. We are passionate about design, and constantly strive to create design solutions that work, right down to the smallest detail.

We operate across nine locations in Australia, New Zealand, London and Dubai, with a total staff of over 400 people. Local teams and directors' expertise allied with the Group's broad experience and resources provide an integrated range of design services including architecture, master planning, interior design and graphic design across a diverse range of project types.

Current and recent projects include the ANA Towers, Robina Town Centre extensions, Jupiters Hotel & Casino extensions, Q1 Tower, Nexus Towers and Harbour Town on the Gold Coast, Apple Flagship Stores in Sydney and Beijing, Fortitude Valley Railway Station, Vision Tower and Wintergarden redevelopment in Brisbane, Element on Coolum Beach, Pepper's Resort on Magnetic Island, Ipswich RiverLink Shopping Centre, the Christchurch Art Gallery in New Zealand, Westfield London and the Village Centre The Palm in Dubai.

hilton hotel & residences

gold coast, queensland

The Buchan Group's striking design for the new Hilton Surfers Paradise Hotel and Residences located on the key site of the old Dolphin Arcade.

This new development will contribute significantly to the connection of the city's collection of active public spaces, pedestrian links and view corridors.



The \$700M project incorporates residential, commercial office, entertainment, dining and retail components in two major towers and podium, and will create a memorable Gold Coast landmark.

The use of AutoCAD, Revit and 3Ds Max worked greatly to our advantage in this project, from concept design to design development and documentation. A complex project in a large office, the interoperability of the applications at different stages of the project was of key importance in maintaining quality in both design and documentation.

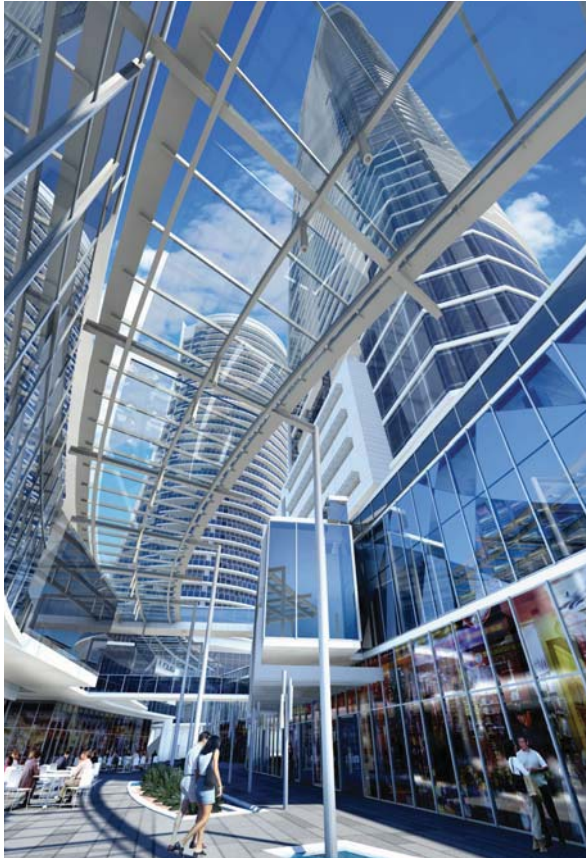

Revit was of particular benefit in the design stage, allowing us to rapidly explore form and special options, solar studies, lighting and contextual effects.

KarelCAD have been a great help in both training and support; we can highly recommend the WISE website as a quick and helpful support option, and their training courses, facilities and CAD Managers' Forum have been invaluable.

